

# outdoor

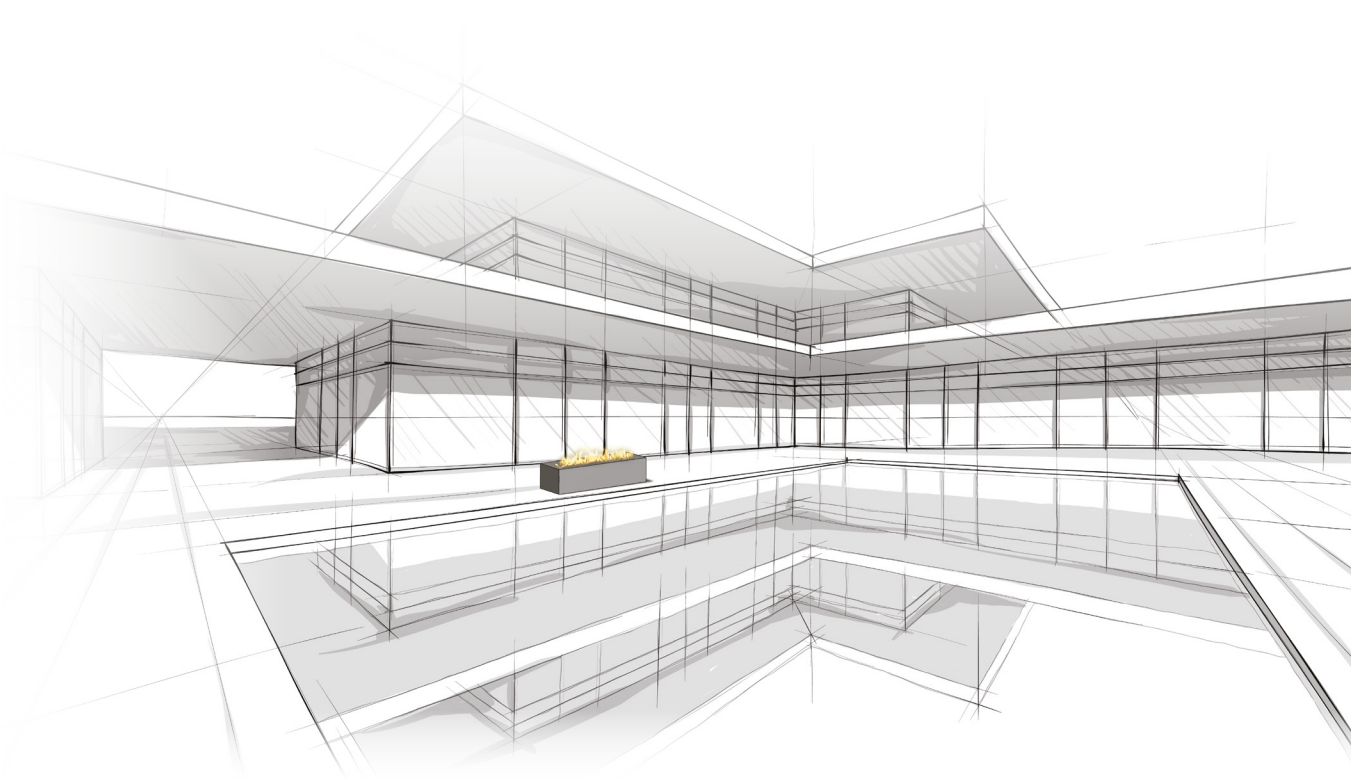

© PLANIKA | Ver. 03072017

[www.PLANIKAfires.com](http://www.PLANIKAfires.com)

# Galio Fire Pit Insert outdoor

## Galio Fire Pit Insert

*A circular insert providing unlimited arrangement possibilities  
Awaken your outdoor space with natural fire*



### FEATURES:

- For outdoor use
- Easy installation
- Flame height regulation
- Fire pit shape burner
- LPG or natural gas powered
- Safety sensor
- No electrical connection required
- CE certified components

### TECHNICAL DATA:

Net weight: 15 kg / 33 lbs

LPG

Heat output net: min. 2,5 kW (8 649 BTU); max. 5,1 kW (17 299 BTU)

Gas rate: min. 0,2 kg/h (0,44 lbs/h); max. 0,4 kg/h (0,88 lbs/h)

Gas pressure: 37 mbar/11" WC

NG

Heat output net: min. 2,4 kW (8 054 BTU); max. 4,7 kW (16 108 BTU)

Gas rate: min. 0,25 m<sup>3</sup>/h (8,8 ft<sup>3</sup>/h); max. 0,5 m<sup>3</sup>/h (17,7 ft<sup>3</sup>/h)

Gas pressure: 20 mbar/7" WC

Finish:

stainless steel

### DIMENSIONS:

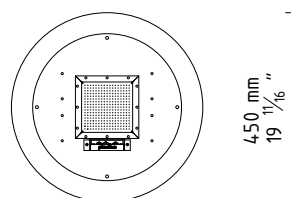
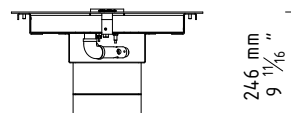
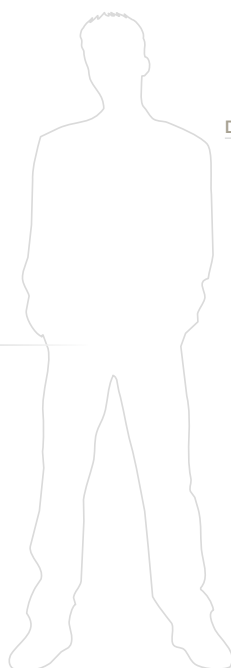

### INSTALLATION REQUIREMENTS:

